

HIGHVAC NW FLANGES AND HARDWARE

NW FLANGE COMPONENTS

CENTERING RING ASSEMBLY - 304 SS

PART NUMBER	BUNA N/ SILICONE/VITON®		UNIT PRICE			
	A	B	BUNA	SILICONE	VITON®	
NW10-050-SR-	B, S, or V	.39	.21	\$5.00	\$6.50	\$6.50
NW16-075-SR-	B, S, or V	.63	.21	\$4.25	\$6.50	\$6.50
NW25-100-SR-	B, S, or V	.98	.21	\$6.50	\$7.50	\$8.25
NW40-150-SR-	B, S, or V	1.53	.21	\$10.00	\$11.00	\$11.00
NW50-200-SR-	B, S, or V	1.97	.21	\$12.00	\$14.00	\$15.00

Add B, S or V to the part number to state o-ring type

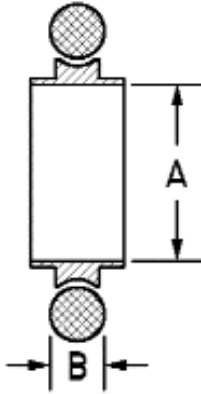

CENTERING RING ASSEMBLY - ALUMINUM

PART NUMBER	BUNA N/ SILICONE/VITON®		UNIT PRICE			
	A	B	BUNA	SILICONE	VITON®	
NW10-050-AR-	B, S, or V	.39	.21	\$3.00	\$5.50	\$6.00
NW16-075-AR-	B, S, or V	.63	.21	\$3.00	\$5.50	\$6.00
NW25-100-AR-	B, S, or V	.98	.21	\$4.00	\$6.50	\$6.50
NW40-150-AR-	B, S, or V	1.53	.21	\$5.25	\$9.00	\$9.00
NW50-200-AR-	B, S, or V	1.97	.21	\$6.50	\$11.00	\$11.00

Add B, S or V to the part number to state o-ring type

CENTERING RING ASSEMBLY - BRASS

PART NUMBER	BUNA N/ SILICONE/VITON®		UNIT PRICE			
	A	B	BUNA	SILICONE	VITON®	
NW10-050-BR-	B, S, or V	.39	.21	\$3.00	\$5.50	\$6.00
NW16-075-BR-	B, S, or V	.63	.21	\$3.00	\$5.50	\$6.00
NW25-100-BR-	B, S, or V	.98	.21	\$4.00	\$6.50	\$6.50
NW40-150-BR-	B, S, or V	1.53	.21	\$5.25	\$9.00	\$9.00
NW50-200-BR-	B, S, or V	1.97	.21	\$6.50	\$11.00	\$11.00

Add B, S or V to the part number to state o-ring type

Viton® is a registered trademark of DuPont Dow Elastomers

Buna (-B) 100°C maximum

Viton® (-V) 200°C maximum

Silicone (-S) 200°C maximum;
chemical applications

CENTERING RING ASSEMBLY

304 STAINLESS STEEL WITH SCREEN

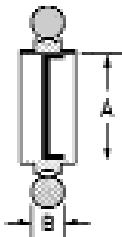

PART NUMBER	A	B	PRICE
NW10-050-SRV-SM	.31	.21	\$28.50
NW16-075-SRV-SM	.50	.21	\$28.50
NW25-100-SRV-SM	.86	.21	\$32.25
NW40-150-SRV-SM	1.45	.21	\$38.25
NW50-200-SRV-SM	1.88	.21	\$42.00

72 mesh stainless steel screen, includes viton® O-ring

OVER PRESSURE RING - 304 STAINLESS STEEL

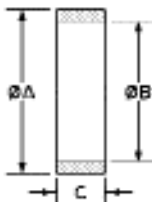

PART NUMBER	A	B	MAX C	PSIG	UNIT PRICE
NW10-050-OPR	1.25	1.09	.14	100	\$8.00
NW16-075-OPR	1.25	1.19	.35	100	\$9.00
NW25-100-OPR	1.66	1.58	.35	100	\$9.50
NW40-150-OPR	2.25	2.17	.35	75	\$10.75
NW50-200-OPR	2.75	2.62	.15	50	\$12.00

Provides support for o-ring when operating above ATM



HIGHVAC, Co.

7191 SE 182nd Place , Inglis, Florida 34449

Phone : (352) 447-7033 Fax : (352) 447-1222

Shop online: WWW.HIGHVAC.NET

